



**SOFTROL  
WATER  
SOFTENERS**





---

**AUSTRALIA**

Phone: **1300 140 140**

Email: **[sales@puretec.com.au](mailto:sales@puretec.com.au)**

Web: **[puretec.com.au](http://puretec.com.au)**

**NEW ZEALAND**

Phone: **0800 130 140**

Email: **[sales@puretec.co.nz](mailto:sales@puretec.co.nz)**

Web: **[puretec.co.nz](http://puretec.co.nz)**



**Soft water benefits from a superior water softener appliance.**

Use less detergents. Clean bathrooms and dishes more easily. Reduces scum, towels and linens are softer and appliances last longer. The benefits are almost endless, and shouldn't be underestimated.

Puretec Softrol's guaranteed systems combine the latest in innovation and 25 years of experience in the harshest environments.

## Puretec Softrol™ benefits around the house

### Rumpus Room

Drinks mixed with Softrol™ water simply taste better. So do juices. Now ice cubes look clearer and more appealing.

### Laundry

Clothes are much softer, look whiter & brighter and use up to 75% less detergent. Appliances will also last longer.

### Utility Area

Your Puretec Softrol™ protects against premature hot water system replacement and many other appliances/fixtures.



### Cleaning Cupboard

Clean-up chores are easier thanks to the tremendous cleaning action of Softrol™ water. Clean-up is more economical because you'll need far less household cleaner.

### Kitchen Tap

You enjoy peace of mind knowing your Softrol™ water is always pure and refreshing. Prepared foods taste more natural. Fruit and vegetables rinsed in Softrol™ water are more appetising.

### Dishwasher

Your glassware is now clear and shiny with no scale, smears or spots. Appliances can wear out up to 40% faster without soft water.

### Bathroom

Soap and shampoo rinse out more completely, leaving skin and hair cleaner, softer, more residue free and looking much better! The shower screen is easier to clean too.

## Money in your pocket

It is normally expected that a Puretec Softrol™ would extend the life of household appliances like your hot water unit, washing machines, dishwashers, coffee makers, humidifiers and plumbing by **as much as 40%**. It is well known that in very hard water areas that these appliances can last up to **20 times longer** because hard water is so hard on appliances when scaling builds up; particularly on heating elements, you have to use a lot more power to heat up your water. You'll also discover that soap and shampoo lathers quicker **with up to 70% less** detergent! Statistics tell us that we spend between 17 and 21 cents of every dollar on cleaning products . . . imagine the savings and discover all that **new unspent money** with a Puretec Softrol™!

# WHAT'S INSIDE

## **Softrol™** Water Softeners

What is Puretec Softrol™ .....	7
A selection of the Puretec Softrol™ range .....	8
The E3, Efficient, Effective and Eco-friendly.....	9
SOL-SE Series	
Semi-automatic Water Softening Appliance.....	10
SOL-E1 Series	
Automatic Timer Water Softening Appliance.....	12
SOL-E3 Series	
Automatic Volume Water Softening Appliance.....	14



Hard water is water that contains dissolved minerals such as limestone, lead, iron, sulphur, magnesium, and calcium. If these minerals are not removed from your water, they will cause scaling, eventually blocking plumbing and shortening the life of appliances particularly hot water units, dishwashers, washing machines etc.

#### **Effortless**

With Puretec Softrol™ your silverware and glassware, are cleaner and shinier. Your hair and skin feels softer, cleaner and smoother. Puretec Softrol™ helps rinse soap residue more thoroughly, leaving your clothing and dishes as well as your hair and skin looking and feeling cleaner.

#### **Longevity**

Minerals found in hard water build up in household appliances such as hot water systems and dishwashers reducing their service life and making them less efficient. Obviously, soft water saves you money by replacing them less often and saves the environment by cutting waste.

#### **Efficiency**

Water softened with a Puretec Softrol™ water softener appliance heats up more quickly. This saves power on gas consumption at a massively reduced rate estimated for electric hot water systems of 22% and gas hot water units 29%.

#### **Dependable**

Our impeccable manufacturing standards are derived from our commercial operations, where there's no margin for error. The products have been tested in the harshest environment and every Puretec Softrol™ comes with a 3 year warranty.

## Select from the advanced Puretec Softrol™ controllers

Parameters / Model	SE model	E1 model	E3 model
3 Year warranty	✓	✓	✓
Made in USA	✓	✓	✓
Durable design	✓	✓	✓
Polyethylene body	✓	✓	✓
High grade resin	✓	✓	✓
Recyclable	✓	✓	✓
Free Technical Phone Support	✓	✓	✓
Large capacity Brine Tank	✓	✓	✓
Easy Lid Access	✓	✓	✓
Weather Cover	✓	✓	✓
Intelligent Regeneration	-	✓	✓
Automatic Controller	-	✓	✓
Integrated Water Meter	-	-	✓
Automatic Capacity Calculator	-	-	✓

## Puretec Optional Accessories

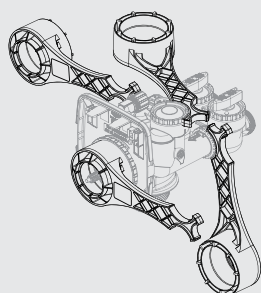

**Spanner**  
Suits E1 & E3 Valve  
Ordering Code: **WTV5180**



**Bypass Assembly**  
Suits E1 & E3 Valve  
Ordering Code: **WTV5000**



Efficient.  
Effective.  
Eco-friendly.  
The **E3**.

**State of the Art E3 Valve**

If no water is used it won't backwash. When it does according to the water volume used and water quality, it will choose a convenient time when water generally isn't used.

**User Friendly, Functional Controller**

Solid state microprocessor with easy access front panel settings. Backwash controller has less moving parts for reliability.

**Easy Lid Access**

Functional lid design with large opening means easy topping up of the brine tank and keeps the dirt out.

**Water, Energy and Money Saving**

The integrated water meter monitors usage for precise regeneration and efficient salt usage. Backwash controller has less moving parts for reliability and durability.

**High Grade Premium Resin**

This means less regeneration needed, higher capacity per unit and longer resin life.

**Durable Cabinet**

Polyethylene body, durable and designed for the harshest environment. Includes a weather cover for outdoor installation.

**Technical support**

Call our helpline for free assistance at  
**1300 140 140** (AU) | **0800 130 140** (NZ)  
or visit our website [puretecgroupp.com](http://puretecgroupp.com)





The Puretec Softrol™ semi-automatic water softening systems are our most economical units. Requiring no power, the unit incorporates a unique twist timer. Simply twist the timer to initiate a regeneration when necessary and the unit regenerates for the nominated time then returning back to normal softening mode.





## SOL-SE Series

### Semi-Automatic Water Softening Appliance

#### WHOLE HOUSE PROTECTION

These systems provide peace-of-mind water softening throughout the house. You'll notice benefits all through the house. Soap and shampoo's will lather better, your skin will not be as dry, and soap scum will be reduced. Clothes are softer and hot water appliances will last many more years.

#### EASY TO MAINTAIN, NO POWER REQUIRED

The Puretec SOL-SE Series systems are designed for the budget-conscious householder. These systems do not require power to operate. Very easy to maintain, Simply twist the timer to initiate a regeneration when necessary and the unit regenerates for the nominated time then returning back to normal softening mode.

- No power required
- Weather cover for outdoor installation
- Large capacity brine tank
- Semi-automatic twist timer
- Simple, durable and very reliable

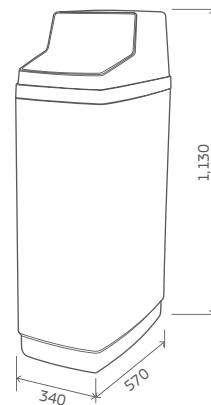
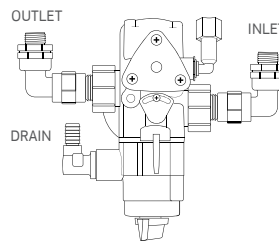

#### Available Models

	SOL30-SE	SOL40-SE
Size of Residence	 Small to Medium	 Medium to Large
Service Flow Rate	30 Lpm <sup>^</sup>	40Lpm <sup>^</sup>
Maximum Pressure	825 kPa	825 kPa
Capacity	12,000 litres	18,000 litres
Connection	20mm F or 15mm M [3/4" F or 1/2" M]	
Drain	12.5 mm tube	

<sup>^</sup>Based on a hardness of 130ppm



The Puretec Softrol™ Automatic Timer water softening systems requires less maintenance than the semi-auto systems. After the initial installation simply set the times and dates requiring backwash and the unit automatically regenerates.





## SOL-E1 Series

### Automatic Timer Water Softening Appliance

#### WHOLE HOUSE PROTECTION

These systems provide peace-of-mind water softening throughout the house. You'll notice benefits all through the house. Soap and shampoo's will lather better, your skin will not be as dry, and soap scum will be reduced. Clothes are softer and hot water appliances will last many more years.

#### EASY TO MAINTAIN, SET AND FORGET

The Puretec SOL-E1 Series systems uses an E1-Matic™ valve that backwashes automatically on a preset time. After the initial installation, simply set the times and dates requiring backwash and the unit automatically regenerates. Power usage is extremely low similar to that of a garden watering system.

- Regenerates automatically
- 1-99 day timer or 7 day timer controller
- 10 selectable programmed cycles
- Intelligent use of water
- 12 volt transformer
- Reliable, durable and simple

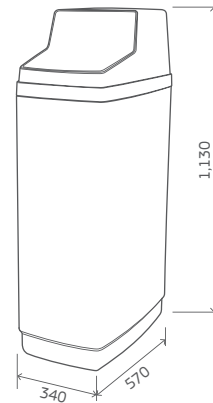
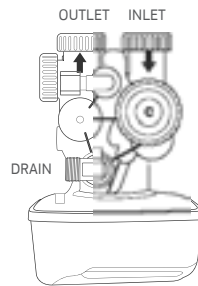

Available Models	SOL30-E1	SOL40-E1
Size of Residence	 Small to Medium	 Medium to Large
Service Flow Rate	30 Lpm <sup>^</sup>	40Lpm <sup>^</sup>
Maximum Pressure	875 kPa	875 kPa
Capacity	12,000 litres	18,000 litres
Connection		25 mm M [1" M]
Drain		15mm M
Power required	240V	240V

<sup>^</sup>Based on a hardness of 130ppm



The Puretec Softrol™ E3 Automatic Volume water softening system is our smartest unit. Just input the water hardness, time and date and the unit automatically calculates the capacity. It measures the water volume used and initiates a regeneration once the capacity is reached. Saves water, time and money.





## SOL-E3 Series

### Volumetric Water Softening Appliance

#### WHOLE HOUSE PROTECTION



These systems provide peace-of-mind water softening throughout the house. You'll notice benefits all through the house. Soap and shampoo's will lather better, your skin will not be as dry, and soap scum will be reduced. Clothes are softer and hot water appliances will last many more years.

#### RELIABLE, DURABLE, SIMPLE AND ALMOST MAINTENANCE FREE

The Puretec SOL-E3 Series systems uses an E3-Matic™ valve - is the most advanced water softener valve. If no water is used it won't backwash and then when it decides to, it will choose a convenient time when you never use water. Power usage is extremely low similar to that of a garden watering system. Very simple and easy to use.

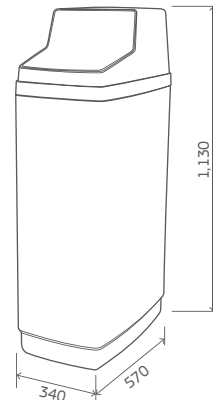
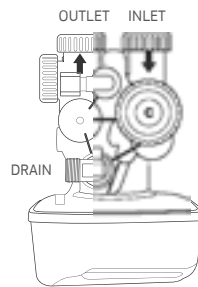
- Less salt, water, power and money used.
- Double backwashing feature
- Optimum regeneration, cleaning and efficiency
- 36 selectable pre-programmed cycles, 3 modes of backwashing
- Highly intelligent use of water
- 1-28 days override
- 1-99 day timer or 7 day timer controller
- Reliable, durable and simple



Available Models	SOL30-E3	SOL40-E3
Size of Residence	 Small to Medium	 Medium to Large
Service Flow Rate	30 Lpm <sup>^</sup>	40Lpm <sup>^</sup>
Maximum Pressure	875 kPa	875 kPa
Capacity	12,000 litres	18,000 litres
Connection		25 mm M [1" M]
Drain		15mm M
Power required	240V	240V

<sup>^</sup>Based on a hardness of 130ppm



**AUSTRALIA**

Customer Service: **1300 140 140**

Email: [sales@puretec.com.au](mailto:sales@puretec.com.au)

Web: [www.puretec.com.au](http://www.puretec.com.au)

**NEW ZEALAND**

Customer Service: **0800 130 140**

Email: [sales@puretec.co.nz](mailto:sales@puretec.co.nz)

Web: [www.puretec.co.nz](http://www.puretec.co.nz)